

## Overview

EtherWAN offers its Media Converter Series as a concrete and affordable answer in response to an increase in fibre optics cabling deployment. EtherWAN's EL50 Series is one of the most complete solutions in media conversion. The EL50 Series is available in all varieties of fibre connectors and modes: The EL50 is a reasonably priced and user friendly media converter that supports easy to read LEDs which indicate Link and Activity status. In addition, the EL50 is the most functional media converter on the market. The RJ-45 port on this unit can Auto negotiate 10/100Mbps duplex mode and Auto-MDIX. Better than a regular converter, the EL50 has switching capability that is able to filter traffic and record MAC addresses



## Features

- Supports Link-Fault-Pass-Through
- 768K bits buffer memory
- 10/100Mbps-Full/Half-duplex, Auto-Negotiation, Auto-MDI/MDIX
- Full wire-speed forwarding rate
- 12VDC external PSU
- 0°C to 45°C (32°F to 113°F) operating temperature range
- Metal case
- Supports Desktop installation

## Ordering Information

EL50T	10/100BASE-TX to 100BASE-FX Multi Mode (ST) Media Converter
EL50C	10/100BASE-TX to 100BASE-FX Multi Mode (SC) Media Converter
EL50T-20	10/100BASE-TX to 100BASE-FX Single Mode (ST) -20 Km Media Converters
EL50C-20	10/100BASE-TX to 100BASE-FX Single Mode (SC) -20 Km Media Converters
EL50C-40	10/100BASE-TX to 100BASE-FX Single Mode (SC) -40 Km Media Converters
EL50CA-2	10/100BASE-TX to 100BASE-BX Multi Mode (SC) WDM -TX: 1310nm/RX: 1550nm -2 Km Media Converters
EL50CB-2	10/100BASE-TX to 100BASE-BX Multi Mode (SC) WDM -TX: 1550nm/RX: 1310nm -2 Km Media Converters
EL50CA-5	10/100BASE-TX to 100BASE-BX Multi Mode (SC) WDM -TX: 1310nm/RX: 1550nm -5 Km Media Converters
EL50CB-5	10/100BASE-TX to 100BASE-BX Multi Mode (SC) WDM -TX: 1550nm/RX: 1310nm -5 Km Media Converters
EL50CA-20	10/100BASE-TX to 100BASE-BX Single Mode (SC) WDM -TX: 1310nm/RX: 1550nm -20 Km Media Converters
EL50CB-20	10/100BASE-TX to 100BASE-BX Single Mode (SC) WDM -TX: 1550nm/RX: 1310nm -20 Km Media Converters
EL50CA-40	10/100BASE-TX to 100BASE-BX Single Mode (SC) WDM -TX: 1310nm/RX: 1550nm -40 Km Media Converters
EL50CB-40	10/100BASE-TX to 100BASE-BX Single Mode (SC) WDM -TX: 1550nm/RX: 1310nm -40 Km Media Converters

### NOTES:

\*More 100FX fibre options are also available upon request.

## Diagrams

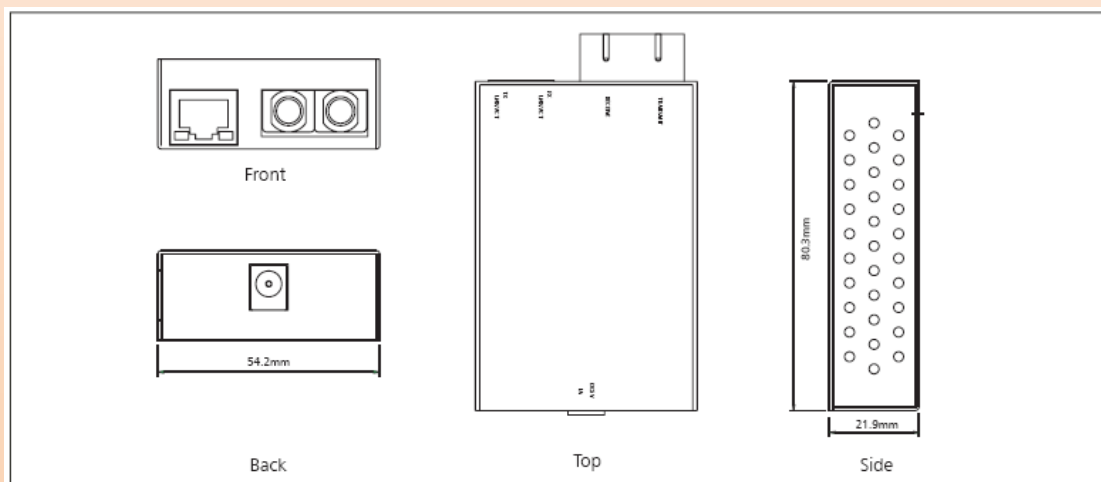

## Specifications

### Technology

#### Standards:

- IEEE802.3 10BASE-T, IEEE802.3u 100BASE-TX/100BASE-FX

#### Forward and Filtering Rate:

- 14,880pps for 10Mbps
- 148,810pps for 100Mbps

#### Packet Buffer Memory:

- 768K bits

#### Processing Type:

- Store-and-Forward

### Power

#### Input:

- Input Voltage: 12VDC

#### Power Consumption:

- 1.92W Max. 0.16A@12VDC

### Mechanical

#### Casing:

- Metal case

#### Dimensions:

- 54.2mm (W) x 80.3mm (D) x 21.9mm (H)  
(2.13" (W) x 3.16" (D) x 0.86" (H))

#### Weight:

- 140g (0.31lb.)

#### Installation:

- Desktop

### Interface

#### Ethernet Port:

- 10/100BASE-TX: 1 port
- 100BASE-FX: 1 port

#### LED Indicators:

- Per Port: 10/100TX: Link/Activity
- 100FX: Link/Activity

### Environment

#### Operating Temperature:

- 0°C to 45°C (32°F to 113°F)

#### Storage Temperature:

- -10°C to 70°C (14°F to 158°F)

#### Ambient Relative Humidity:

- 5% to 95% (non-condensing)

### Regulatory Approvals

#### ISO:

- Manufactured in an ISO9001 facility.

#### Emission Compliance:

- CE Mark Class A, FCC Part 15 Class A , VCCI Class A.

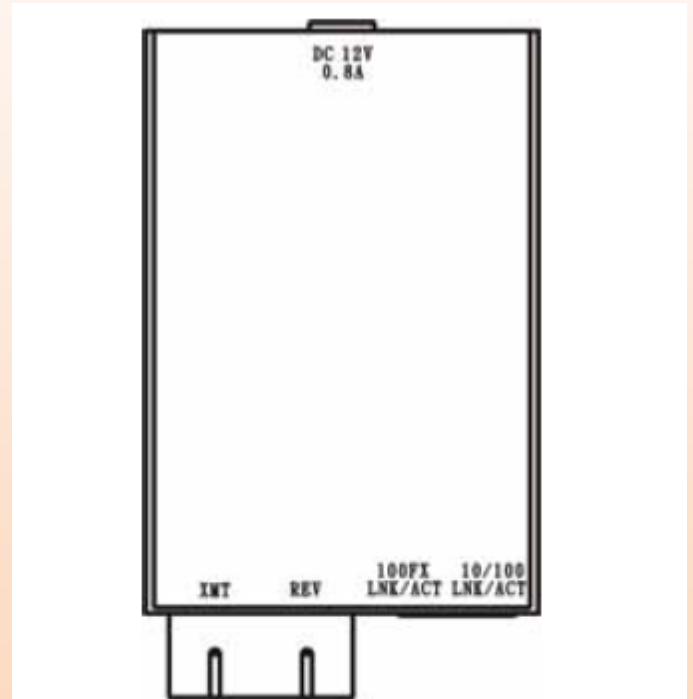
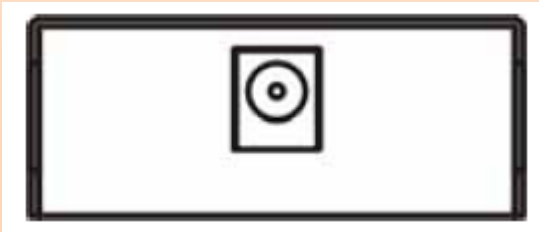
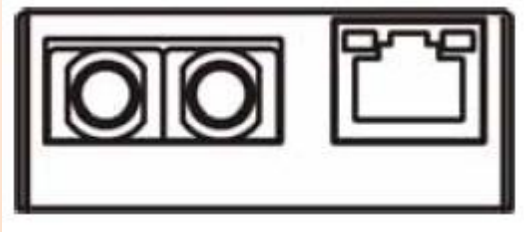

LEDs	State	Indication
TX LNK/ACT FX LNK/ACT	Steady	A valid network connection established LNK stands for LINK
	Flashing	Transmitting (TX) or receiving (RX) data ACT stands for ACTIVITY
	Off	Neither valid network connection established nor transmitting (TX)/receiving (RX) data

